

ENCLOSURE :- 5

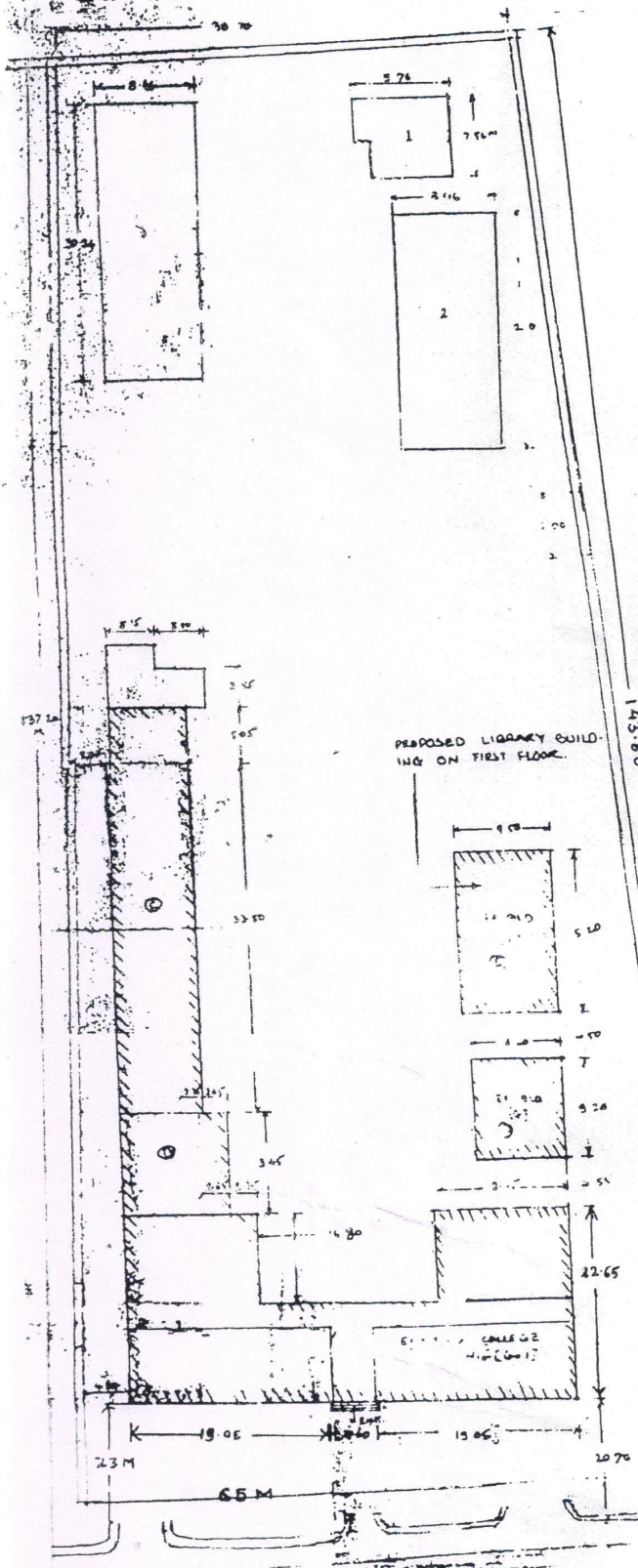

MASTER PLAN FOR AZAD COLLEGE OF EDUCATION SATARA

TOTAL PLOT AREA =  

$$= \left[ \frac{65.00 + 38.70}{2} \right] \times \left[ \frac{37.20 + 143.60}{2} \right]$$

$$= 7273.74 \text{ Sqm}$$
 i.e. 1.00 Acres

- TOTAL B/U AREA
- A = MAIN BUILDING 41.70 x 22.45 = 944.50 Sqm
  - 1680 x 13.15 = 22081.5 Sqm
  - 723.58 Sqm
  - B = SCIENCE LAB - 10.10 x 9.45 = 95.44
  - C = HOSTEL 7.65 x 38.55 = 294.90 Sqm
  - D = PSYCHOLOGY LAB 8.60 x 9.20 = 79.12 Sqm
  - E = LIBRARY 9.50 x 15.20 = 144.40 Sqm
  - TOTAL B/U AREA = 1337.44 Sqm

- EXISTING COLLEGE BUILDING
- PROPOSED PRINCIPAL RESIDENCE
- PROPOSED LADIES HOSTEL
- U.C.R. MASONRY COMPOUND WALL (425MTR)
- BRICK MASONRY COMPOUND WALL (625MTR)
- STAFF QUARTERS

ALL DIMENSIONS ARE IN METERS  
 SCALE 1:100

**DHANE M. S.**  
 (P. CIVIL)  
 En. & Civ. Engineer  
 All India P. Engg. (1981)  
 Tel. Satara

I/C Principal  
 Azad College of Education  
 Satara.

